

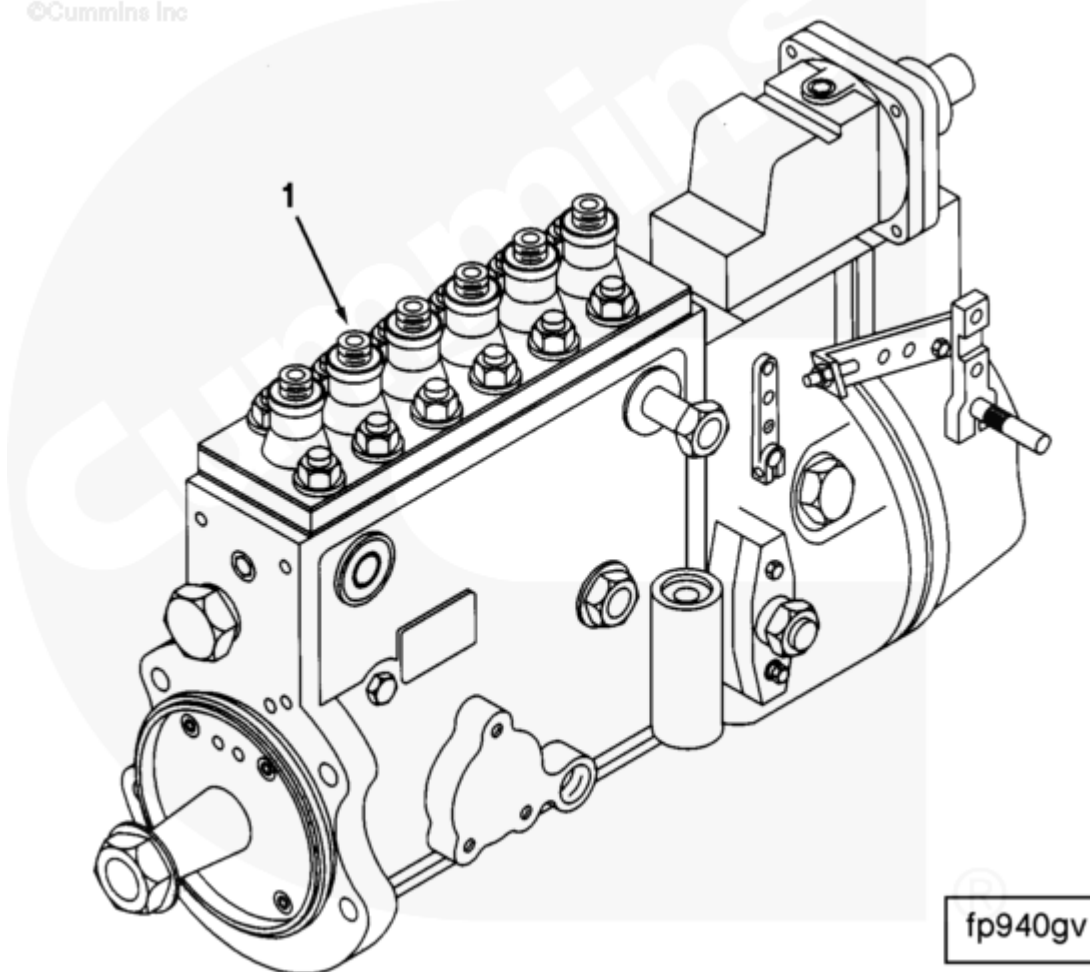

Parts Catalog - Option Detail

Electronic Parts Catalog - Option Detail				
Option	Group	Graphic	Film Card	Date
FP97710-01	05.21	fp940gv	Z	11-JAN-97
Engines	6C8.3, C GAS PLUS CM556, G8.3, G8.3 CM558, GTA8.3 CM558, ISC CM2150, ISC CM554, ISC CM850, ISC8.3 CM2250, ISC8.3 G CM2180 C101, ISL CM2150, ISL CM554, ISL CM850, ISL G CM2180, ISL8.9 CM2150 L110, ISL8.9 CM2880 L112, ISL9 CM2150 SN, ISL9 CM2250, ISL9 CM2350 L101, ISL9 CM2350 L111, ISLE4 CM850, L GAS PLUS CM556, L8.9, L8.9 L121, L8.9G CMOH2.0 L125B, L9 CM2350 L116B, L9 CM2350 L119B, L9 CM2350 L120C, L9 CM2350 L123B, L9.3 L105, L9.5 L117, L9N CM2380 L124B, QSC8.3 CM2250, QSC8.3 CM2880 C102, QSC8.3 CM554, QSC8.3 CM850(CM2850), QSL9 CM2250, QSL9 CM2250 L115, QSL9 CM2350 L102, QSL9 CM2350 L107, QSL9 CM2350 L118, QSL9 CM2350 L122, QSL9 CM554, QSL9 CM850(CM2850), QSL9 G CM558, QSL9 M CM2250 L106, QSL9.3 CM2880 L113			



[SMALL](#) | [MEDIUM](#) | [LARGE](#)

Cart	Ref No	Part Number	Part Description	Required	Remarks
View My Cart					
		FP97710-01	Base Fuel Pump		Fuel Pump...(More)

					Engine Family: C Series
					Engine Cylinders: 6
					Advertised HP: 300 @ 2200
					Governed HP: 275 @ 2400
					Torque Peak (lb-ft): 820 @
					1300
					Fuel Pump Type: Inline
					Pump Manufacturer/Model:
					Bosch P7100
					High Idle: 2710
					Governor Type: RQVK
					High Pressure Tube ID (mm):
					1.8
					Boost Control Provided: Yes
					Shutdown Device: Electrical
					Compatible Fuel Rating - FR:
					9748
					CPL: 2105
					Certified by: EPA
					Taiwan EPA
					Certification Year: 1997
					Certification Status:
					Approved
					Governor Break RPM: 2475
					Governor Regulation (%): 9.5
<input type="checkbox"/>	1	3922425	Fuel Injection Pump	1	Recon equivalent 3922425 RX